

MINING COMPANY
EVANS & ASSOCIATES CONSTRUCTION CO., INC.
 3320 NORTH 4TH STREET, PONCA CITY, OKLAHOMA 74602

MINE NAME
BIG FORK RANCH

R 3 E

T

24

N

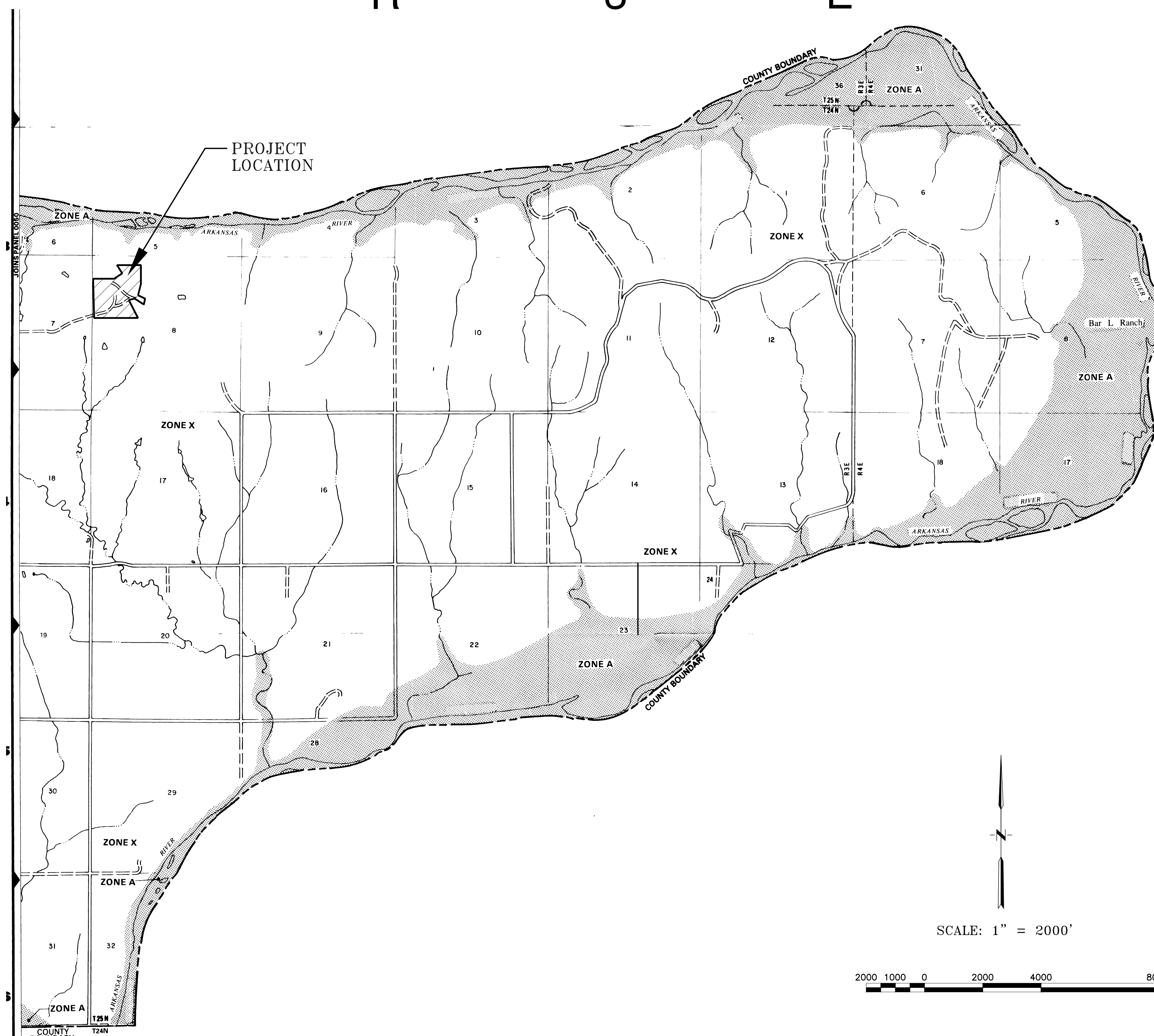

LEGEND

SPECIAL FLOOD HAZARD AREAS INUNDATED BY 100-YEAR FLOOD

- ZONE A** No base flood elevations determined.
- ZONE AE** Base flood elevations determined.
- ZONE AH** Flood depths of 1 to 3 feet (usually area of ponding); base flood elevations determined.
- ZONE AO** Flood depths of 1 to 3 feet (usually sheet flow on sloping terrain); average depths determined; for areas of unusual fan flooding, velocities also determined.
- ZONE A99** To be protected from 100-year flood by Federal flood protection system under construction; no base flood elevations determined.
- ZONE V** Coastal flood with velocity hazard (wave action); no base flood elevations determined.
- ZONE VE** Coastal flood with velocity hazard (wave action); base flood elevations determined.

FLOODWAY AREAS IN ZONE AE

OTHER FLOOD AREAS

- ZONE X** Areas of 500-year flood; areas of 100-year flood with average depths of less than 1 foot or with drainage areas less than 1 square mile; and areas protected by levees from 100-year flood.

OTHER AREAS

- ZONE X** Areas determined to be outside 500-year floodplain.
- ZONE D** Areas in which flood hazards are undetermined.

BOUNDARIES

- County Boundary
- Floodplain Boundary
- Floodway Boundary
- Zone D Boundary
- Boundary Chinking Special Flood Hazard Zones

ELEVATIONS

- 513 Base Flood Elevation Line; Elevation in Feet* (EL 987)
- D Cross Section Line
- RM 7x Base Flood Elevation in Feet Where Uniform Within Zone*
- M1.5 Elevation Reference Mark
- River Mile

*Referenced to the National Geodetic Vertical Datum of 1929

NOTES

This map is for use in administering the National Flood Insurance Program. It does not necessarily identify all areas subject to flooding, particularly from local drainage sources of small size, or all planning features outside Special Flood Hazard Areas. The community map repository should be consulted for possible updated flood hazard information as to use of this map for property purchase or construction purposes.

Coastal base flood elevations apply only to landward of 0.5 NCD, and include the effects of wave action; these elevations may also differ significantly from those developed by the National Weather Service for hurricane evacuation planning.

Area of special flood hazard (100-year flood) include Zones A, AE, AH, AO, A99, V, and VE.

Certain areas not in Special Flood Hazard Areas may be protected by flood control structures.

Boundaries of the floodways were computed at cross sections and interpolated between cross sections. The floodways were based on hydraulic considerations with regard to requirements of the Federal Emergency Management Agency.

Floodway widths in some areas may be too narrow to show scale. Floodway widths are provided in the Flood Insurance Study Report.

For adjoining map panels see separately printed Map Index.

MAP REPOSITORY
 Noble County Courthouse, Perry, Oklahoma 73077 (Maps available for reference only, not for distribution).

INITIAL IDENTIFICATION:
 NOVEMBER 18, 1992

FLOOD HAZARD BOUNDARY MAP REVISIONS:
 NONE

FLOOD INSURANCE RATE MAP EFFECTIVE:
 NOVEMBER 18, 1992

FLOOD INSURANCE RATE MAP REVISIONS:
 NONE

Refer to the Flood Insurance Rate Map Effective date shown on this map to determine when annual rates apply to structures in the zones where elevations or depths have been established.
 To determine if flood insurance is available in this community, contact your insurance agent or call the National Flood Insurance Program at (800) 538-6620.

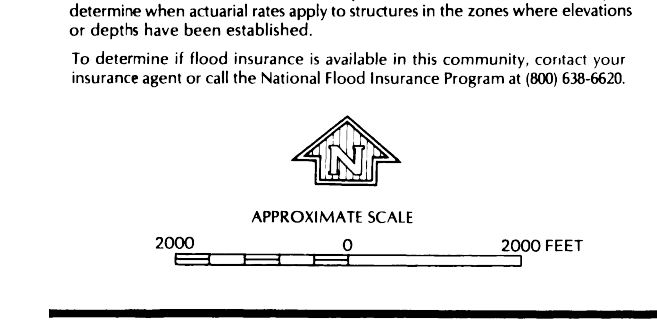

NATIONAL FLOOD INSURANCE PROGRAM

FIRM FLOOD INSURANCE RATE MAP

NOBLE COUNTY, OKLAHOMA (UNINCORPORATED AREAS)

PANEL 75 OF 250
(SEE MAP INDEX FOR PANELS NOT PRINTED)

COMMUNITY-PANEL NUMBER
 400132 0075 A

EFFECTIVE DATE:
 NOVEMBER 18, 1992

Federal Emergency Management Agency

NOBLE COUNTY, OKLAHOMA

LEGEND

- PROPERTY BOUNDARIES
- PERMIT BOUNDARIES
- SURFACE OWNER AND PERCENTAGE
- COAL OWNER AND PERCENTAGE
- FEDERAL COAL LEASE
- BOUNDARIES OF AREA TO BE DISTURBED
- PRIME FARMLAND BOUNDARIES
- TRAIL
- WATERSHED BOUNDARIES
- SECTION LINE
- PRE-MINE CONTOUR
- ANTICIPATED POST-MINE CONTOUR
- COAL STRUCTURAL CONTOUR
- OVERBURDEN ISOPACH
- COAL THICKNESS ISOPACH
- COAL STRIKE AND DIP
- COAL SUBCROP LIMIT
- POWER LINES
- TELEPHONE LINES OR CABLES
- FENCES
- REFERENCE AREA
- BUFFER ZONE
- ARCHAEOLOGICAL SITES
- SURFACE WATER MONITORING POINT
- SURFACE WATER SAMPLING POINT
- EXISTING GROUND WATER MONITORING POINT
- PROPOSED GROUND WATER MONITORING POINT
- GROUND WATER SAMPLING POINT
- EXPLORATORY DRILL HOLE LOCATION AND NUMBER
- PERENNIAL STREAMS
- INTERMITTENT STREAMS
- EPHEMERAL STREAMS

P
 KAW LAND & CATTLE CO., INC.
 FCL
 D
 PF
 W/S
 450
 700
 Z
 T
 R/A
 SWMP
 SWSP
 CWMP #1
 CWMP #1A
 GWSP
 G-2

- CONSTRUCTION NOTES**
1. THERE SHALL BE NO BLASTING WITHIN 300 FEET OF ANY OCCUPIED DWELLING, PUBLIC BUILDING, SCHOOL, CHURCH, HOSPITAL, OR NURSING FACILITY, UNLESS THE NECESSARY APPROVALS ARE OBTAINED.
 2. BUFFER ZONE = (1.5 X MINING DEPTH) + 25 FEET WILL BE ESTABLISHED ALONG THE BOUNDARY OF THE PROPERTY OWNED BY ADJOINING OWNERS ALONG THE HIGHWALL.
 3. CONTACT OKIE DATA AT 1-800-522-6543 TO VERIFY THE LOCATIONS OF THE UTILITY LINES PRIOR TO ANY CONSTRUCTION ACTIVITIES.
 4. PRIOR TO UTILIZING ASH DISPOSAL PIT NOS. 6 AND 7, BERM / CHANNEL NO. 6 SHOULD BE DIVERTED AWAY FROM ASH DISPOSAL PIT NOS. 6 AND 7.

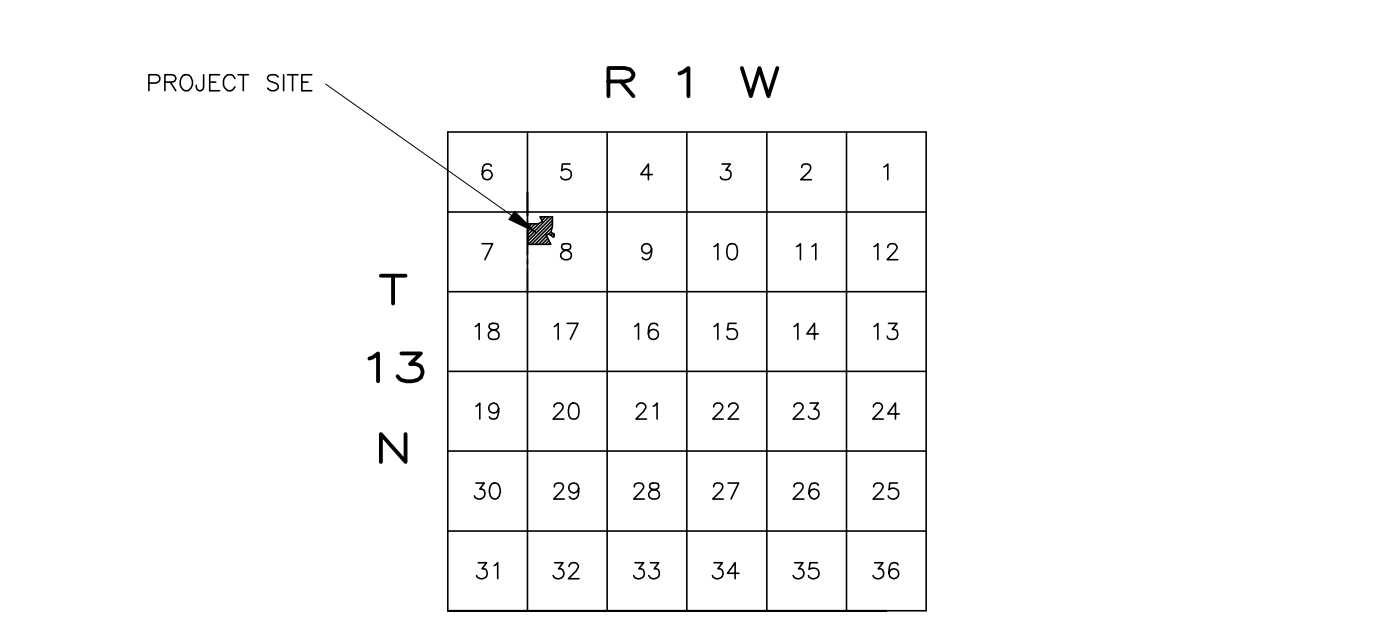

MP-2

PREPARED BY: **EMERA CORPORATION**
P. O. BOX 2228, EDMOND, OK 73083

PREPARED FOR: **EVANS & ASSOCIATES CONSTRUCTION CO., INC.**
3320 NORTH 4TH STREET, PONCA CITY, OKLAHOMA 74602

TITLE OF MAP: **FEDERAL EMERGENCY MANAGEMENT AGENCY (FEMA) FLOOD PLAIN MAP**

DRAWN BY: CET SCALE: 1" = 2000' DATE: 9-13-17
 DRAWING NO: MP-2 SHEET 2 OF 11 REVISED:

NAME OF PROJECT: **BIG FORK RANCH**

LOCATION: **A PART OF SECTION 8, T24N, R3E, NOBLE CO., OKLAHOMA**

PERMIT NO.